

RONDELLE STARLOCK® PER PERNI CILINDRICI

MISURE RONDELLE (espresse in pollici se non diversamente indicato)

A		B	C	Riferimenti capped						
Dimensioni albero	Codice plain	Diametro esterno	Spessore materiale	Codice capped	Dimensione cappuccio	Dome	Axle	Deep Axle	Nylon	Note
1.5mm	6499	6.35mm	0.2mm	6669	0	S				
1.5mm	8004	9.7mm	0.2mm	7204	1	S,K	S,K			Standard
1/16"	6488	.250	.008	6339	0	S				
1/16"	6218	.380	.008	6232	1	S,K	S,K			Standard
1.8mm	8054	9.7mm	0.2mm	8047	1	S,K	S,K			
2mm	6933	6.35mm	0.2mm	7154	0	S				
2mm	6489	9.7mm	0.2mm	6662	1	S,K	S,K			Standard
3/32"	6330	.250	.008	6333	0	S				
3/32"	5883	.380	.008	6221	1	S,K	S,K			Standard
2.5mm	7114	8.5mm	0.2mm							
.104	6823	.380	.008	6892	1	S,K	S,K			
2.7mm	8171	18.4mm	0.2mm	8087	4	S,K	S,K			
3mm	8014	6.35mm	0.2mm	8046	0	S				
3mm	6490	9.7mm	0.2mm	6663	1	S,K	S,K			Standard
3mm	8131	11.5mm	0.2mm	8300	2	S,K	S,K	A		
3mm	7184	14.8mm	0.25mm							
3mm	8068	18.4mm	0.2mm	8078	4	S,K	S,K	A	N	
3mm	8066	28.15mm	0.2mm	8048	6	S,K			N	
1/8"	7025	.250	.008	7161	0	S				
1/8"	5897	.380	.008	6222	1	S,K	S,K			Standard
3.5mm	8006	9.7mm	0.2mm	8032	1	S,K	S,K			
.144	6833	.380	.008	6891	1	S,K	S,K			
5/32"	6707	.375	.008							

5/32"	5928	.450	.008	6223	2	S,K	S,K	A		Standard
4mm	6492	11.5mm	0.2mm	6665	2	S,K	S,K	A		Standard
4mm	7187	11.5mm	0.25mm							
4mm	8059	11.5mm	0.4mm	8045	2	S,K	S,K	A		Usa intenso
4mm	8051	15.25mm	0.25mm	8083	3	S,K	S,K	A	N	
4mm	8064	18.4mm	0.3mm	8043	4	S,K	S,K	A	N	
4mm	8072	25.0mm	0.25mm	8079	5	S,K	S,K		N	
4.5mm	7080	11.5mm	0.2mm	7206	2	S,K	S,K	A		
3/16"	8018	.380	.008	8081	1	S,K	S,K			
3/16"	5920	.450	.008	6224	2	S,K	S,K	A		Standard
3/16"	6500	.450	.012	7245	2	S,K	S,K	A		
3/16"	8058	.450	.016	8073	2	S,K	S,K	A		Usa intenso
3/16"	7127	.600	.010	7201	3	S,K	S,K	A	N	
3/16"	6718	.725	.012	6680	4	S,K	S,K	A	N	
5mm	8153	9.7mm	0.25mm	8312	1	S,K	S,K			
5mm	6491	11.5mm	0.2mm	6664	2	S,K	S,K	A		Standard
5mm	7129	11.5mm	0.3mm	8037	2	S,K	S,K	A		
5mm	8060	11.5mm	0.4mm	8074	2	S,K	S,K	A		Usa intenso
5mm	7077	15.25mm	0.25mm	7250	3	S,K	S,K	A	N	
7/32"	6324	11.5mm	.008	6235	2	S,K	S,K	A		Standard
7/32"	6934	.600	.010	7155	3	S,K	S,K	A	N	
7/32"	7108	.725	.012	8027	4	S,K	S,K	A	N	
6mm	7126	11.5mm	0.2mm	7205	2	S,K	S,K	A		
6mm	8024	11.5mm	0.3mm	8040	2	S,K	S,K	A		
6mm	8114	11.8mm	0.2mm							
6mm	7073	14.5mm	0.25mm							
6mm	6493	15.25mm	0.25mm	6666	3	S,K	S,K	A	N	Standard
6mm	7036	15.25mm	0.35mm	7160	3	S,K				
6mm	8061	15.25mm	0.4mm	8075	3	S,K	S,K	A	N	S,K
6mm	8002	18.4mm	0.3mm	8031	4	S,K	S,K	A	N	
1/4"	5873	.600	.010	6225	3	S,K	S,K	A	N	Standard
1/4"	7068	.600	.014	7244	3	S,K	S,K	A	N	
1/4"	8052	.600	.016	8041	3	S,K	S,K	A	N	Usa intenso
1/4"	7029	.725	.012	7159	4	S,K	S,K	A	N	
		.983	.010	8302	5	S,K	S,K		N	
1/4"	8181	.450	.008	8203	2	S,K	S,K	A		

6.75mm	7030	18.4mm	0.25mm	7158	4	S,K	S,K	A	N	
7mm	6703	15.25mm	0.25mm	6670	3	S,K	S,K	A	N	Standard
7mm	8149	15.25mm	0.4mm	8085	3	S,K	S,K	A	N	Usa intenso
9/32"	6326	.600	.010	6236	3	S,K	S,K	A	N	Standard
9/32"	6937	.725	.010	7167	4	S,K	S,K	A	N	
9/32"	6938	.983	.010	7168	5	S,K	S,K		N	
9/32"	7136	1.437	.010	8028	7	S			N	
5/16"	5821	.600	.010	6226	3	S	S	A	N	Standard
5/16"	7037	.600	.012	7169	3	S	S	A	N	
5/16"	8063	.600	.016	8042	3	S	S	A	N	Usa intenso
8mm	6704	15.25mm	0.25mm	6671	3	S	S	A	N	Standard
8mm	8062	15.25mm	0.4mm	8076	3	S	S	A	N	Usa intenso
8mm	7192	18.4mm	0.3mm	7207	4	S	S	A	N	
8mm	7067	25.0mm	0.3mm	7243	5	S	S		N	
8.5mm	7101	15.25mm	0.25mm	8033	3	S	S	A	N	
11/32"	6332	.725	.012	6238	4	S	S	A	N	Standard
11/32"	7109	.983	.012	8029	5	S	S		N	
9mm	6708	18.4mm	0.3mm	6674	4	S	S	A	N	Standard
.365	6213	.725	.012	6233	4	S,K	S	A	N	
3/8"	6020	.725	.012	6227	4	S	S	A	N	Standard
3/8"	6931	1.625	.020	7153	9	S			N	
10mm	6496	18.4mm	0.3mm	6668	4	S	S	A	N	Standard
10mm	8130	18.4mm	0.4mm	8082	4	S	S	A	N	
10mm	7074	25.0mm	0.4mm	7249	5	S	S		N	
13/32"	6331	.725	.012	6239	4	S	S	A	N	Standard
13/32"	7110	.983	.012	7208	5	S	S		N	
11mm	6706	18.4mm	0.3mm	6673	4	S	S	A	N	Standard
7/16"	6494	.725	.012	6661	4	S	S	A	N	
7/16"	6216	.983	.016	6228	5	S	S		N	Standard
12mm	6713	25.0mm	0.4mm	6675	5	S	S		N	Standard
12mm	8179	28.15mm	0.4mm	8304	6	S				
1/2"	6143	.983	.016	6229	5	S	S		N	Standard
13mm	6829	25.0mm	0.4mm	6885	5	S	S		N	Standard
17/32"	6325	.983	.016	6237	5	S	S		N	Standard
14mm	7065	23.0mm	0.4mm							
14mm	7078	25.0mm	0.4mm	8034	5	S	S,K		N	

14mm	6825	28.15mm	0.4mm	6881	6	S			N	Standard
15mm	8193	25.0mm	0.4mm							
15mm	6714	28.15mm	0.4mm	6676	6	S			N	Standard
5/8"	6720	.983	.008	8077	5	S	S		N	
5/8"	6185	.983	.016	6231	5	S	S		N	Standard
16mm	6826	28.15mm	0.4mm	6882	6	S			N	Standard
17mm	6715	28.15mm	0.4mm	6677	6	S			N	Standard
18mm	8001	28.15mm	0.4mm	8035	6	S			N	
18mm	8125	31.0mm	0.3mm							
18mm	6827	36.5mm	0.4mm	6883	7	S			N	Standard
18.4mm	8110	28.15mm	0.4mm	8306	6	S				
19mm	6828	36.5mm	0.4mm	6884	7	S			N	Standard
3/4"	6323	1.437	.008	8307	7	S				
3/4"	6322	1.437	.016	6234	7	S			N	Standard
19.85mm	8069	28.15mm	0.4mm	8308	6	S				
20mm	6716	36.5mm	0.4mm	6678	7	S			N	Standard
20mm	8057	36.5mm	0.5mm	8309	7	S				
20mm	8109	41.28mm	0.4mm	8310	9	S				
20mm	8160	28.0mm	0.5mm							
21mm	6830	36.5mm	0.4mm	6886	7	S			N	Standard
22mm	6719	36.5mm	0.4mm	6889	7	S			N	Standard
22mm	8161	29.8mm	0.5mm							
7/8"	6328	1.500	.018	6335	8	S				Standard
23mm	6831	38.1mm	0.45mm	6887	8	S				Standard
24mm	7035	38.1mm	0.45mm	7241	8	S				
24mm	6832	41.28mm	0.5mm	6888	9	S			N	Standard
25mm	8103	38.1mm	0.3mm	8311	8	S				
25mm	6717	41.28mm	0.5mm	6679	9	S			N	Standard
1"	8150	1.625	.012	8084	9	S			N	
1"	6329	1.625	.020	6334	9	S			N	Standard
27mm	7194	41.28mm	0.5mm	8036	9	S			N	
1 1/8"	7061	1.625	.020	7248	9	S			N	
30mm	8124	44.0mm	0.5mm							
30mm	8104	50.0mm	0.5mm							

Le rondelle piane sono disponibili in acciaio brunito, in acciaio inox (alcune misure) o zincate.

I cappucci possono essere in acciaio inox (S), in alluminio (K) in acciaio brunito zincato (A) ed in nylon (N)

TIPI DI CAPPUCCIO PER VERSIONE CAPPED

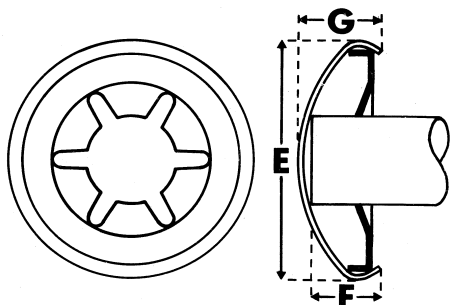

CAPPUCCIO DOME

	E	F	G
Dimensioni	Diametro esterno	Profondità massima di penetrazione del perno	Altezza
0	7,20	1,40	2,70
1	10,67	2,54	3,05
2	12,32	3,05	3,76
3	16,32	4,06	5,08
4	19,81	4,50	5,80
5	26,00	6,00	7,50
6	29,40	7,00	9,00
7	38,20	8,70	11,70
8	39,80	9,53	12,95
9	43,00	9,53	12,45

Misure espresse in mm.

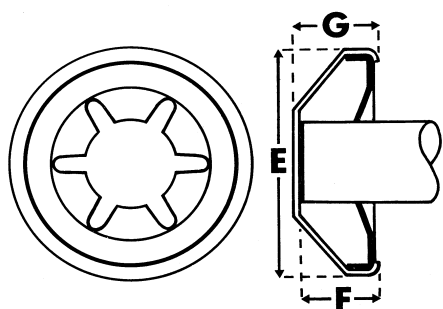

CAPPUCCIO A TRONCO DI CONO (AXLE)

	E	F	G
Dimensioni	Diametro esterno	Profondità massima di penetrazione del perno	Altezza
1	10,67	3,43	3,96
2	12,45	4,06	4,45
3	16,26	4,55	5,08
4	19,82	5,50	5,97
5	26,11	6,86	7,24

Misure espresse in mm.

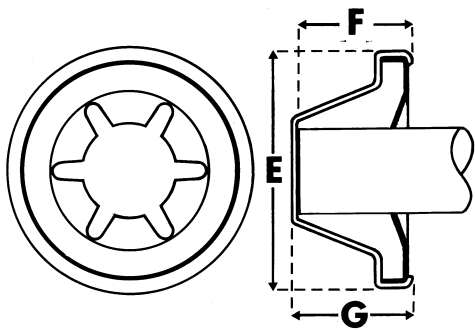

TRONCO DI CONO ALTO (DEEP AXLE)

	E	F	G
Dimensioni	Diametro esterno	Profondità massima di penetrazione del perno	Altezza
2	12,32	5,50	5,69
3	16,13	6,70	7,20
4	19,74	7,70	8,13

Misure espresse in mm.

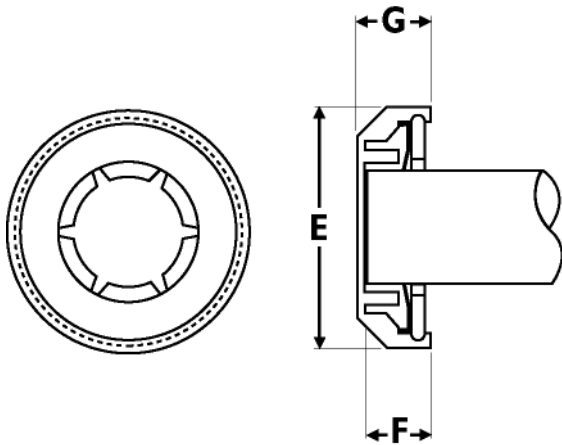

CAPPUCCIO IN NYLON

	E	F	G
Dimensioni	Diametro esterno	Profondità massima di penetrazione del perno	Altezza
3	19,00	5,50	6,50
4	23,00	6,50	7,50
5	30,00	8,00	9,00
6	33,00	10,00	11,00
7	41,00	11,00	12,00
9	46,00	13,00	14,00

Misure espresse in mm.